

39-72

PARK PLACE TOWNHOMES

Lying in Section 26 Township 43 South, Range 42 East, Palm Beach County, Florida.

September 1979

STATE OF FLORIDA
COUNTY OF PALM BEACH
THIS PLAT WAS FILED FOR
RECORD AT _____ DAY OF _____
AD, 1980, AND DULY RECORDED
IN PLAT BOOK _____ ON PAGE(S) _____
AND _____
JOHN B. DUNKLE, CLERK
CIRCUIT COURT
BY: _____

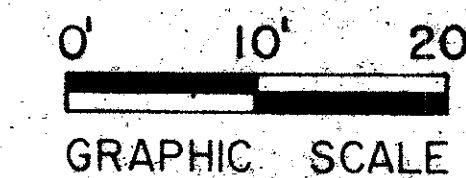

NOTE: FOR PURPOSES OF THIS DETAIL SHEET, NORTH VARIES FROM BLOCK TO BLOCK. SEE SHEET 2 OF 3.

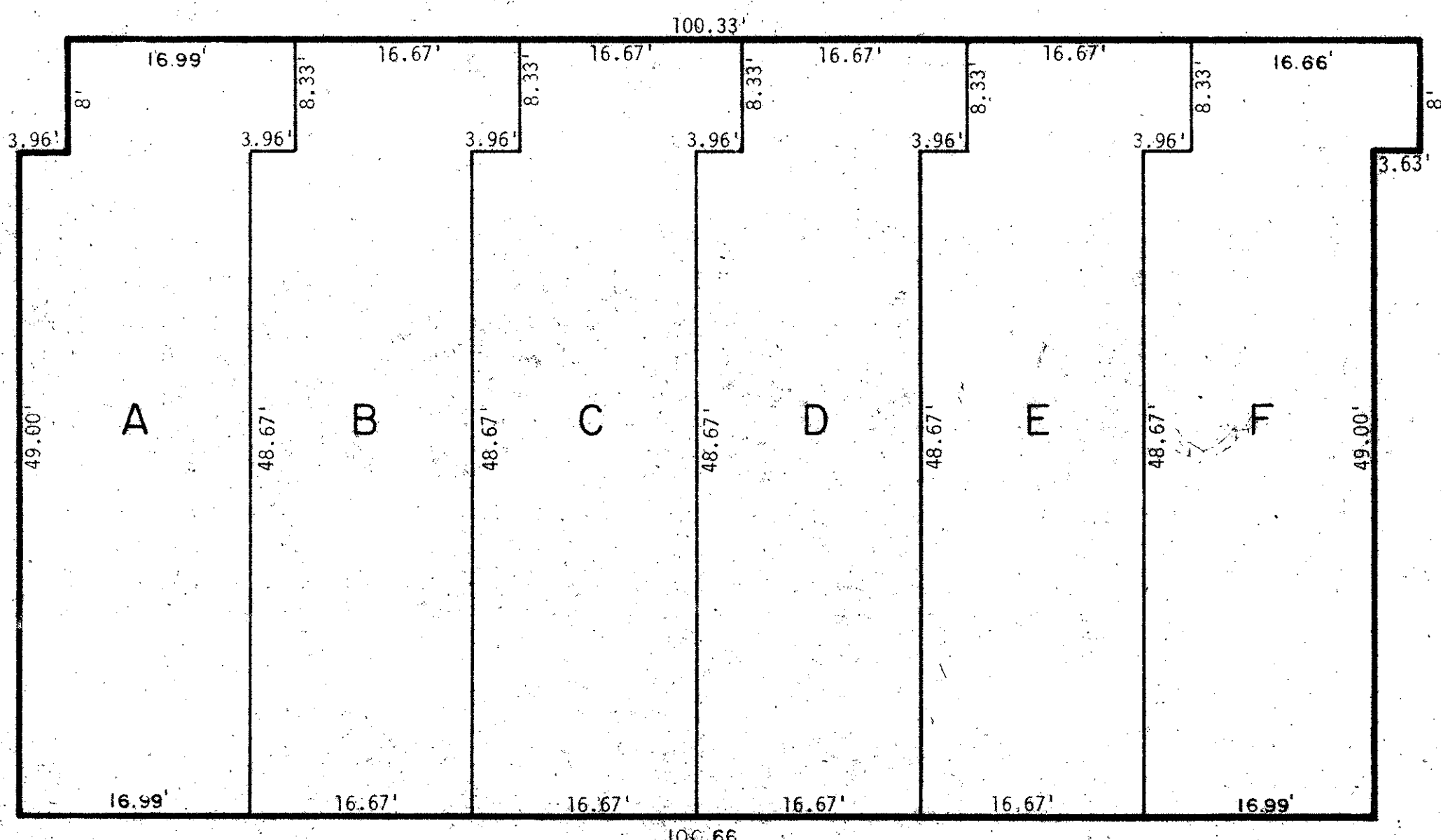

TYPICAL LOT and BLOCK DETAIL
For Lots Within Blocks 6, 7, 20 & 21

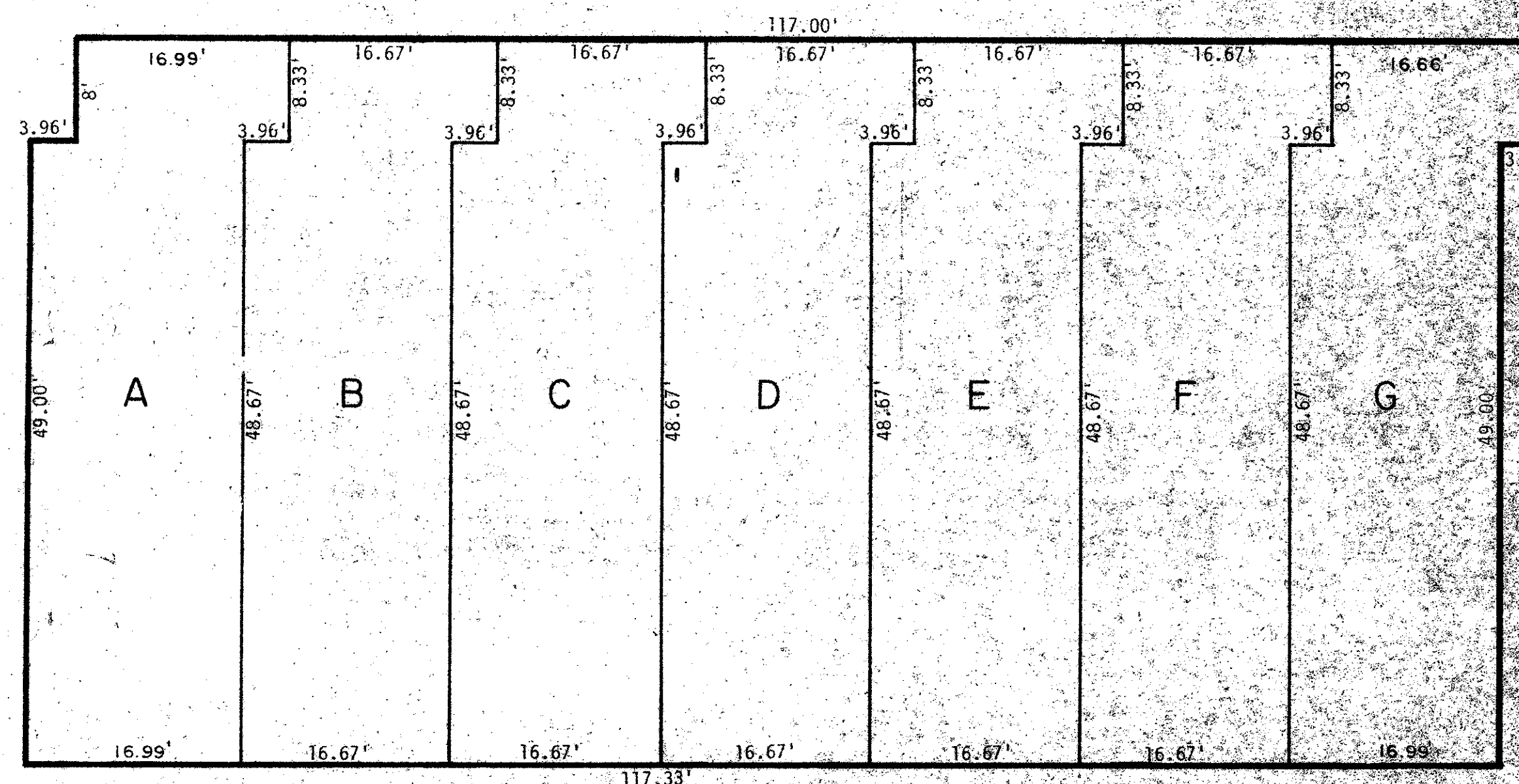

TYPICAL LOT and BLOCK DETAIL
For Lots Within Blocks 4, 5, 8, 9, 13, 14, 18, 19, 22, 23, 27 & 28

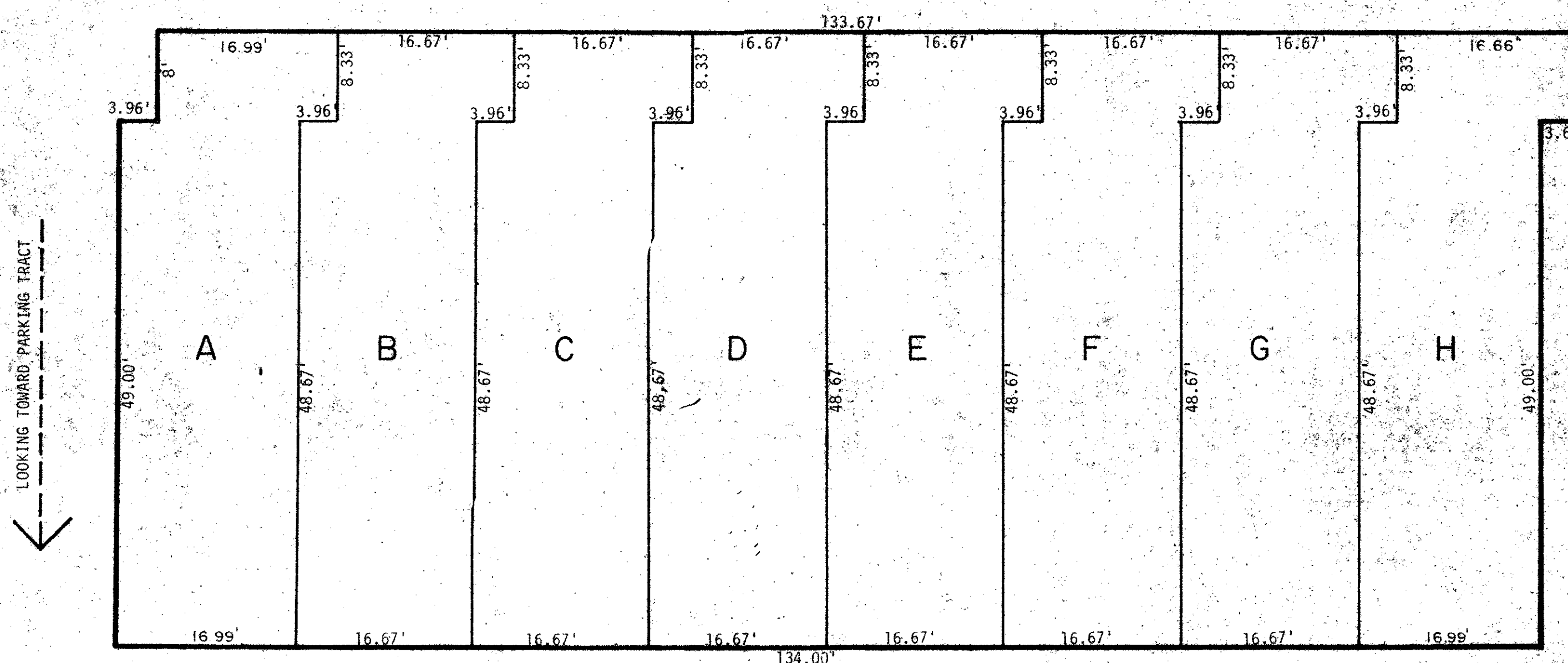

TYPICAL LOT and BLOCK DETAIL
For Lots Within Blocks 1, 2, 3, 10, 11, 12, 15, 16, 17, 24, 25 & 26

- NOTES:
1. ALL LOT LINE INTERSECTIONS ARE AT RIGHT ANGLE INTERSECTIONS WITH ONE ANOTHER.
 2. ALL BLOCK LINE INTERSECTIONS ARE AT RIGHT ANGLE INTERSECTIONS WITH ONE ANOTHER.
 3. ALL LOTS ARE DESIGNATED BY LETTERS RUNNING FROM LEFT TO RIGHT WHEN VIEWED FROM THE PARKING TRACT.

0202-002

BENCH MARK
land surveying and mapping, inc.

CONRAD W. SCHAEFER CONSULTING ENGINEERS, INC.
PALM BEACH COUNTY, FLORIDA

PARK PLACE TOWNHOMES

RECORD PLAT

CMS	1985	9/11	67/00
0-21-75	10		

39/72